

Under Contract

Ref No	248/17
Date	24/08/2017
Scale	A
Drawn	M
Checked	M
Approved	A
Owner	M

GROUND FLOOR PLAN

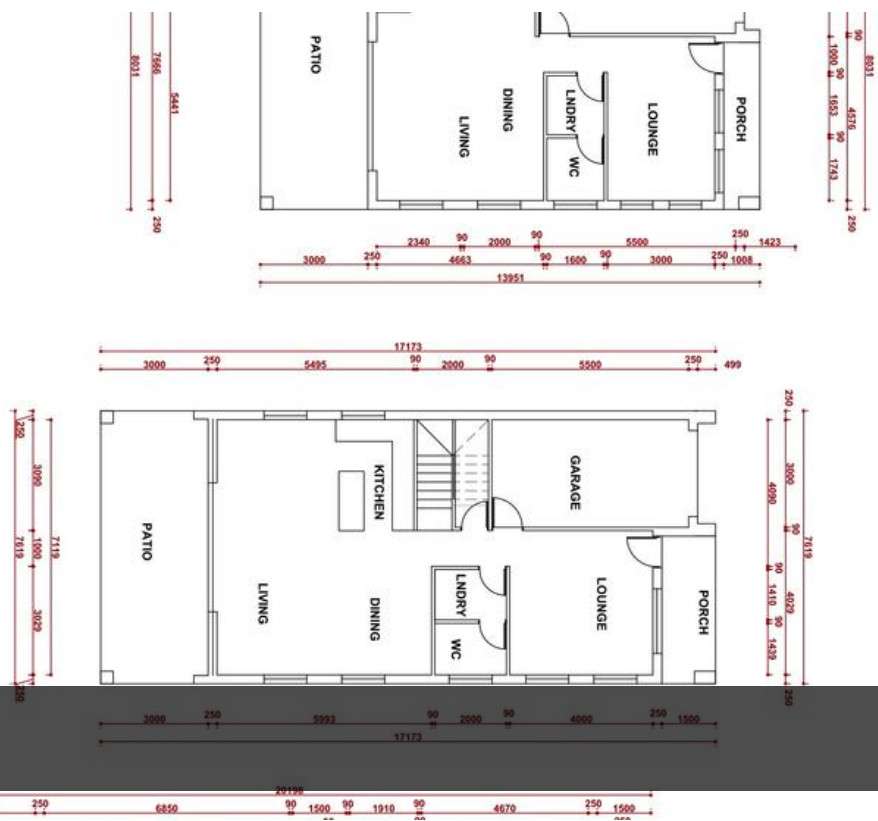

94 Reilly St, Liverpool



Attention Developers: 94-96 Reilly street Liverpool

6 2

Our agency has one of the most substantial opportunities for potential development, its extraordinary regional location in the heart of Liverpool is a well-suited feature as it is close to all amenities including shopping malls , park across the road and a close proximity to neighboring train stations including public transport accessibility.

**Price** price negotiable  
**Property Type** residential  
**Property ID** 12  
**Land Area** 1,382 m2

This exquisite 1382 square meter combined land size approx. and 55.691 SQM frontage approx. possesses impeccable prospect for 5 spaciouly separate dwellings (S.T.C.A) architectural plans and surveyor report has been completed, whats left is DA subject to council approval .

**Auction**  
 Saturday 26 May, 12:00 PM

The site features:  
 94 Reilly st:

**Agent Details**  
 Yvette Soliman - 02 8385 4990

Land size · 715 Sam approx

**Office Details**  
 Key Smart Realty  
 Unit 17 2 Willison Rd Carlton NSW 2218  
 Australia  
 02 8385 4990

The above information provided has been furnished to us by the vendor/s. We have not verified whether or not that information is accurate and do not have any belief in one way or the other in its accuracy. We do not accept any responsibility to any person for its accuracy and do no more than pass it on. All interested parties should make and rely upon their own inquiries in order to determine whether or not this information is in fact accurate.

